

■ = humidifier ■ = dehumidifier → = location of air shaft/channel
 Floor plan of basement (l) and ground floor (r); (A) gas stove. Table shows estimated capacity of radiators (90/70/20°C supply/return water/room temp. system)
 (Source: Museum Amstelkring advisory report TU/E concept March 2006)

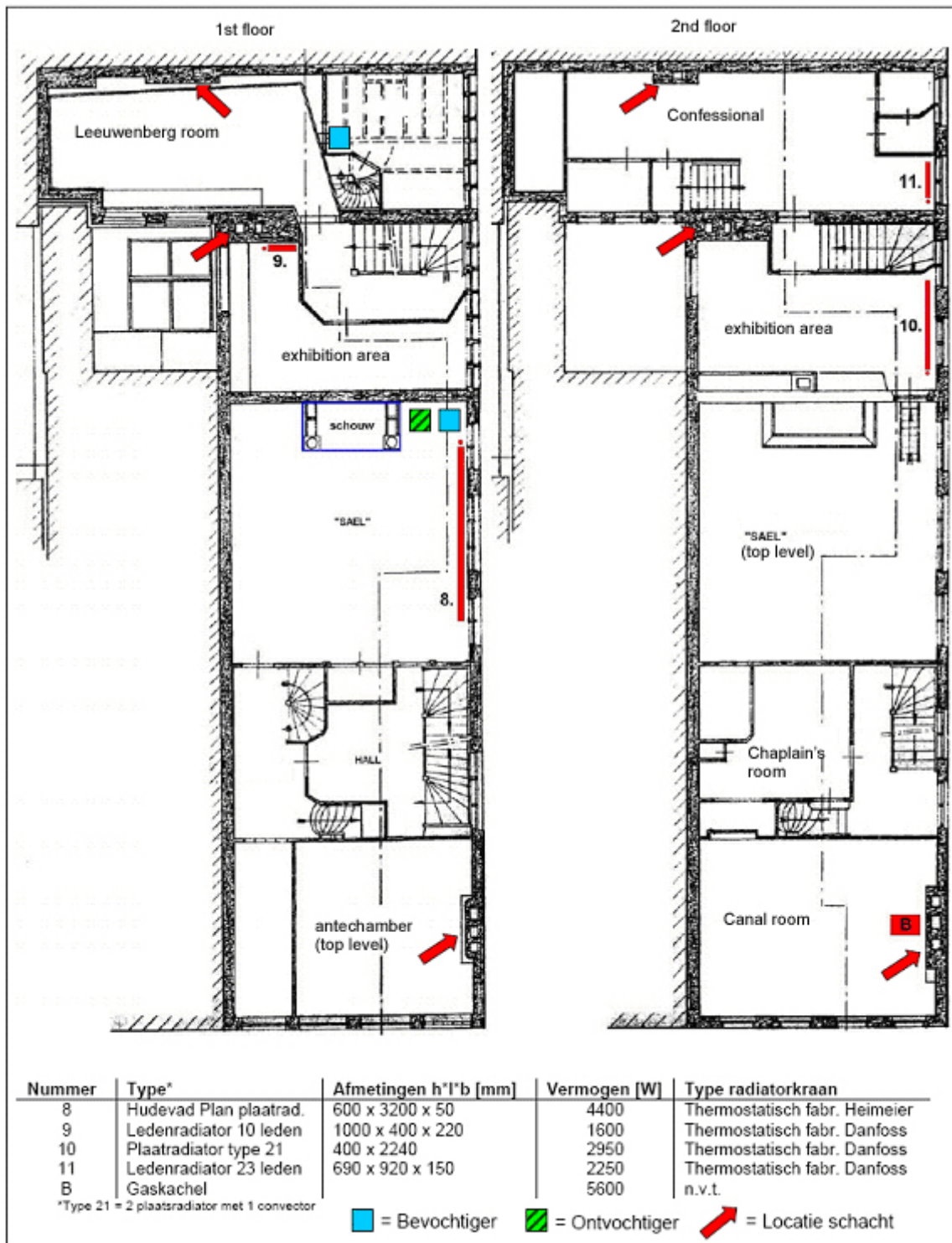

■ = humidifier
 ■ = dehumidifier
 ➔ = location of air shaft/channel
 Floor plan of the first (l) and second floor (r); (B) gas stove. The table shows the estimated capacity of the radiators represented by a 90/70/20°C supply/return water/room temperature system. (Source: Museum Amstelkring advisory report TU/E concept March 2006)

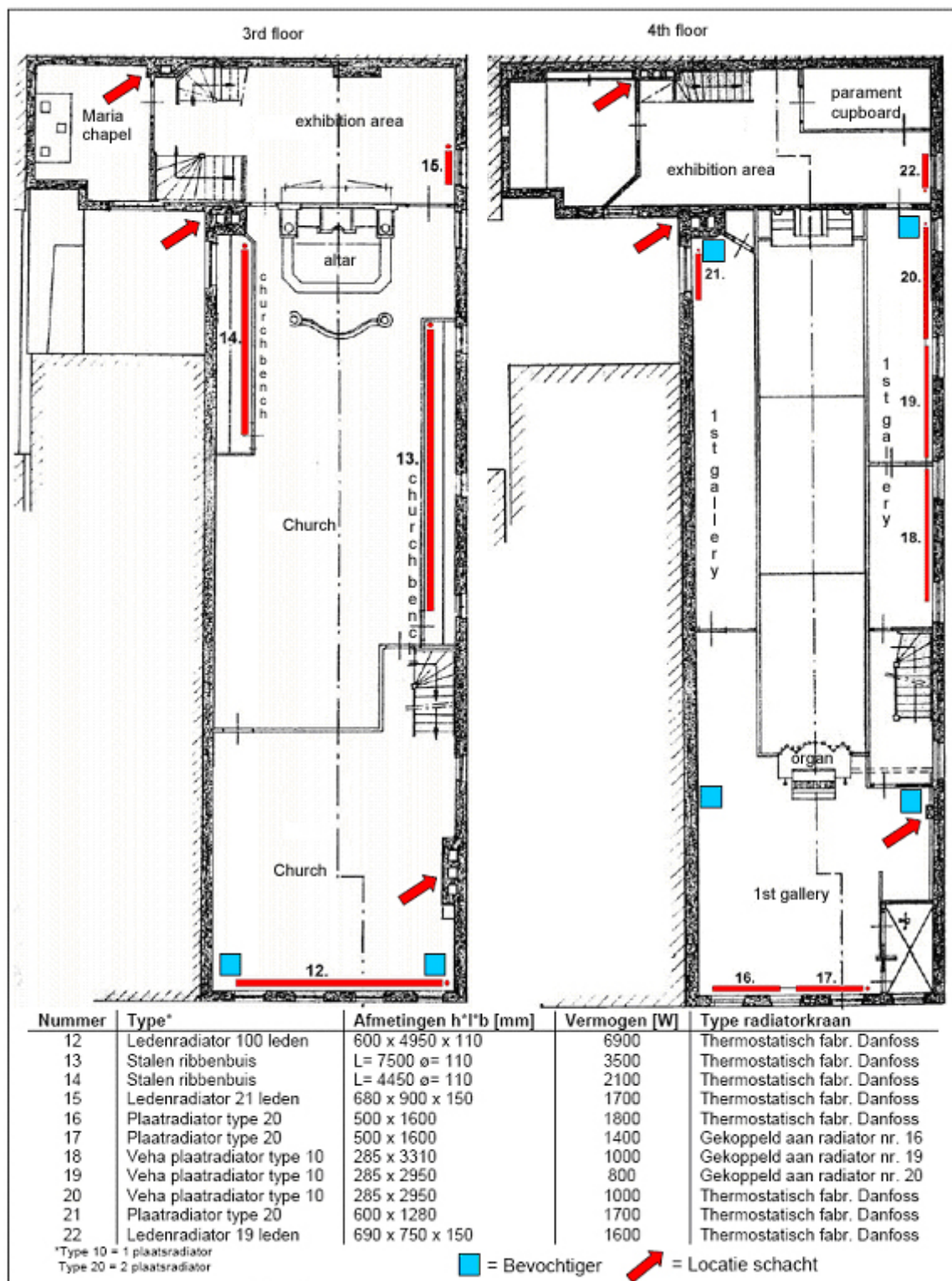

■ = humidifier ■ = dehumidifier → = location of air shaft/channel
 Floor plan of the third (l) and fourth floor (r). The table shows the estimated capacity of the radiators (90/70/20°C supply/return water/room temperature system).
 (Source: Museum Amstelkring advisory report TU/E concept March 2006)

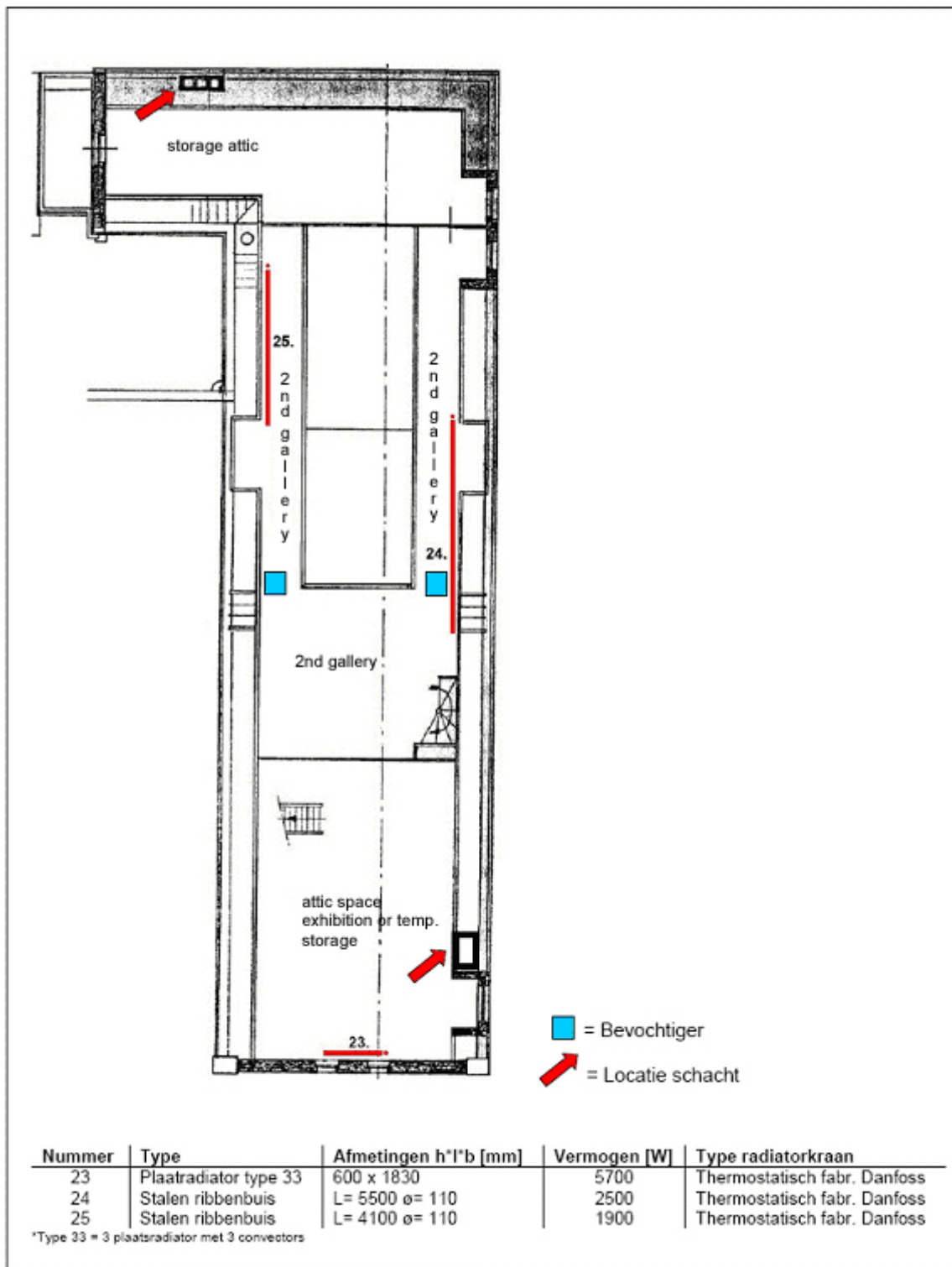

■ = humidifier
 ■ = dehumidifier
 ➔ = location of air shaft/channel

Floor plan of the fifth floor. The table shows the estimated capacity of the radiators represented by a 90/70/20°C supply/return water/room temperature system.

(Source: Museum Amstelkring advisory report TU/E concept March 2006)